

Type : UU Cores (1)

Ordering Code:

Shape:

A10	UU10.5	L
Material	Core Size	Lapping
材質	品名	鏡面拋光

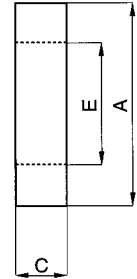
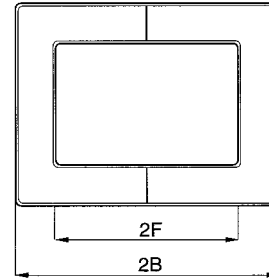

■ DIMENSIONS AND EFFECTIVE PARAMETERS

CORES	DIMENSIONS (mm)					EFFECTIVE PARAMETERS				
	A	B	C	E	F	$C_e(\text{mm}^{-1})$	$L_e(\text{mm})$	$A_e(\text{mm}^2)$	$V_e(\text{mm}^3)$	$Wt(\text{g/set})$
UU9.8	9.80 ± 0.20	7.20 ± 0.10	2.70 ± 0.20	4.20min	4.20 ± 0.20	4.30	34.00	8.00	271.00	1.26
UU10.5	10.50 ± 0.25	8.00 ± 0.30	5.00 ± 0.15	5.35min	5.30 ± 0.30	3.14	40.00	13.00	518.00	2.52
UU15	15.20 ± 0.70	11.40 ± 0.50	6.45 ± 0.25	5.20min	6.25 ± 0.35	1.58	51.00	33.00	1673.00	8.16
UU16	16.00 ± 0.30	10.00 ± 0.20	6.00 ± 0.15	6.70min	6.00 ± 0.15	1.93	52.00	27.00	1381.00	6.56

■ ELECTRICAL CHARACTERISTICS

CORES	$AL \pm 25\% (\text{nH/N}^2)$				$AL \pm 30\% (\text{nH/N}^2)$	
	P4	P5	A05	A07	A10(L)	A121(L)
UU9.8	500	450	930	1300	1600	
UU10.5	720	650	1220	1650	2800	2800min
UU15	1350	1300	2680	3320	6000	
UU16	1140	1050	2140	2720	5710	5100min

Remark:

1. AL Value Testing Condition : 10kHz, 50mV, 100Ts. If testing condition is different from ACME's, please specify upon request & ordering.
2. L : Mirror Finished Lapping. Please specify upon request & ordering by adding "L" at the end of Core Size if you need.

Type : UU Cores (2)

Ordering Code:

Shape:

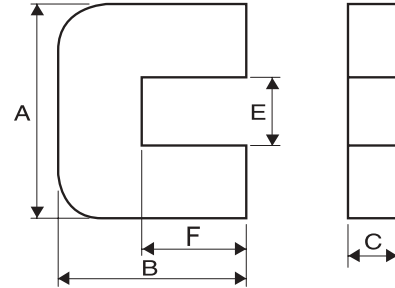
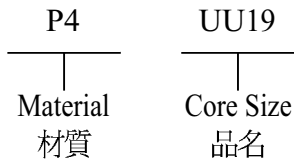

■ DIMENSIONS AND EFFECTIVE PARAMETERS

CORES	DIMENSIONS (mm)					EFFECTIVE PARAMETERS				
	A	B	C	E	F	$C_l(\text{mm}^{-1})$	$L_e(\text{mm})$	$A_e(\text{mm}^2)$	$V_e(\text{mm}^3)$	$Wt(\text{g/set})$
UU13.5	13.50 ± 0.25	10.50 ± 0.10	3.55 ± 0.20	4.15 ± 0.15	7.90 ± 0.10	5.07	18.87	3.72	70.20	3.72
UU19	19.05 ± 0.15	17.00 ± 0.15	2.00 ± 0.10	4.25 ± 0.10	11.60 ± 0.15	5.47	70.60	12.90	910.74	7.30

■ ELECTRICAL CHARACTERISTICS

CORES	$AL \pm 25\% (\text{nH/N}^2)$				$AL \pm 30\% (\text{nH/N}^2)$	
	P4	P5	A05	A07	A10(L)	A121(L)
UU13.5	680					
UU19	500					

Remark:

1. AL Value Testing Condition : 10kHz, 50mV, 100Ts. If testing condition is different from ACME's, please specify upon request & ordering.
2. L : Mirror Finished Lapping. Please specify upon request & ordering by adding "L" at the end of Core Size if you need.